

OMNI

PLATING SYSTEM
MTP Fusion

Plate.
Screw.
Post.

Consistent Plantar Compression



One System – Offering the advantage of plantar-side compression, plus every other MTP fixation option

Dorsal Plate with Modular PlantarFiX™ Post

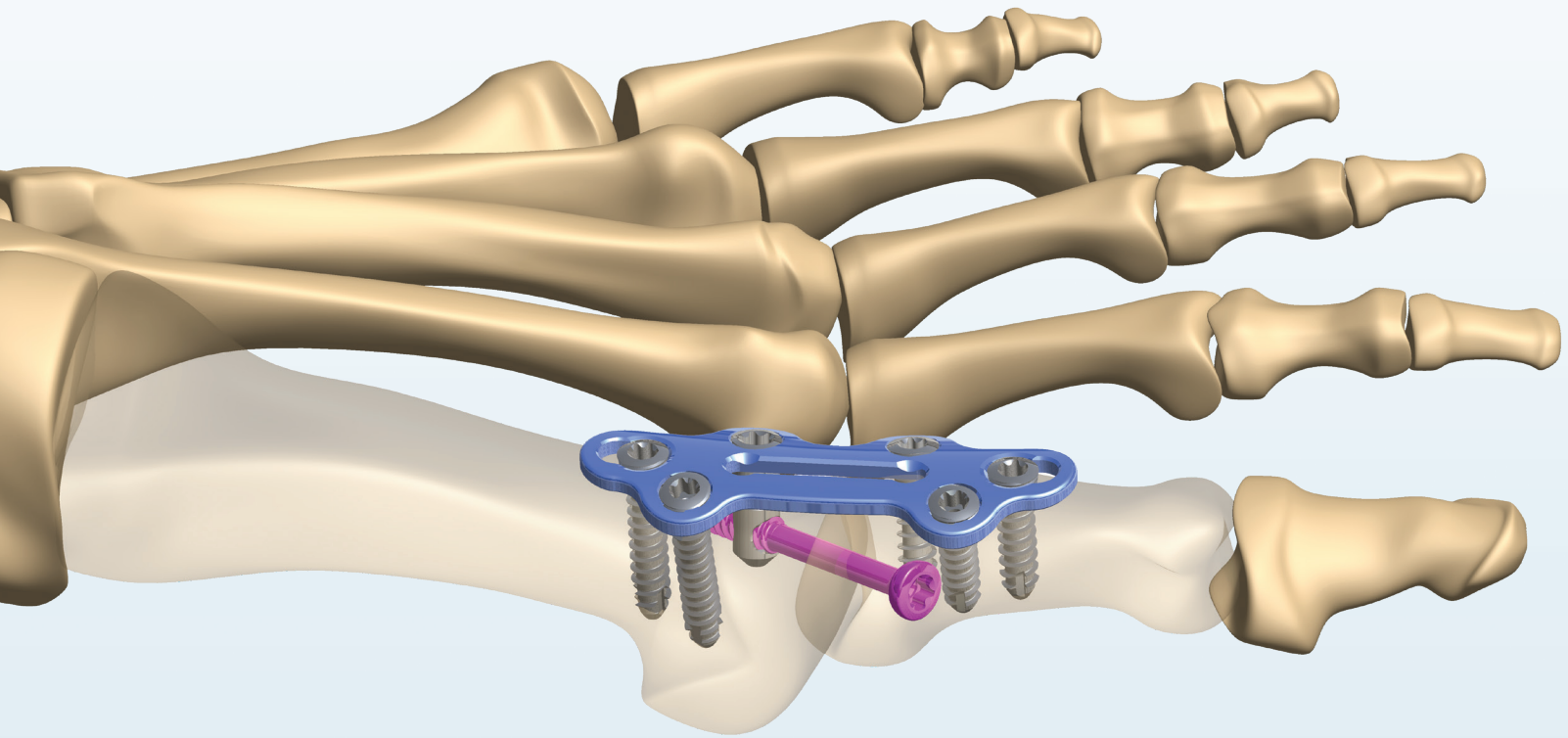

The PlantarFiX™ Post Advantage Designed to Deliver:

Consistent Plantar-side Compression

- Post acts as a metal cortex
- Lag Screw interdigitates with Post **plantarly** (where it is needed most)
 - Lag compression not dependent on bone quality
 - Better lag screw purchase = better compression

Increased Stability

- Lag Screw/Post interface enhances pull-out strength

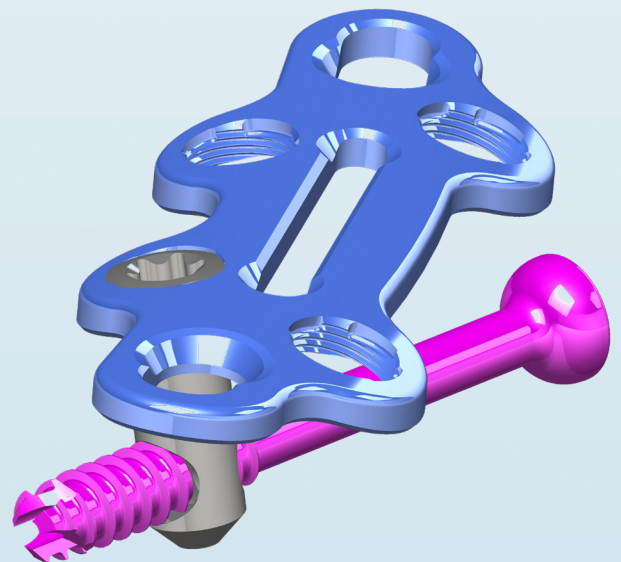

One System – Offering the advantage of plantar-side compression, plus every other MTP fixation option

PlantarFiX™ Post

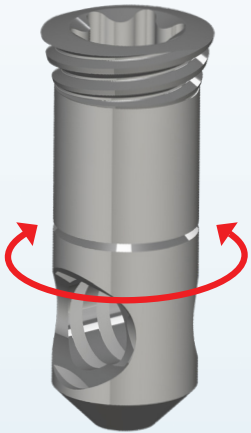

Post Allows for Flexible Screw Placement

- Post can be used in any locking hole
- Post is available in multiple lengths
- Post's swivel-design allows for 360° rotation

Targeting Guide

- Guide is keyed to the PlantarFiX™ Post
- Distal hole in Post is coupled with guide, ensuring accurate screw targeting

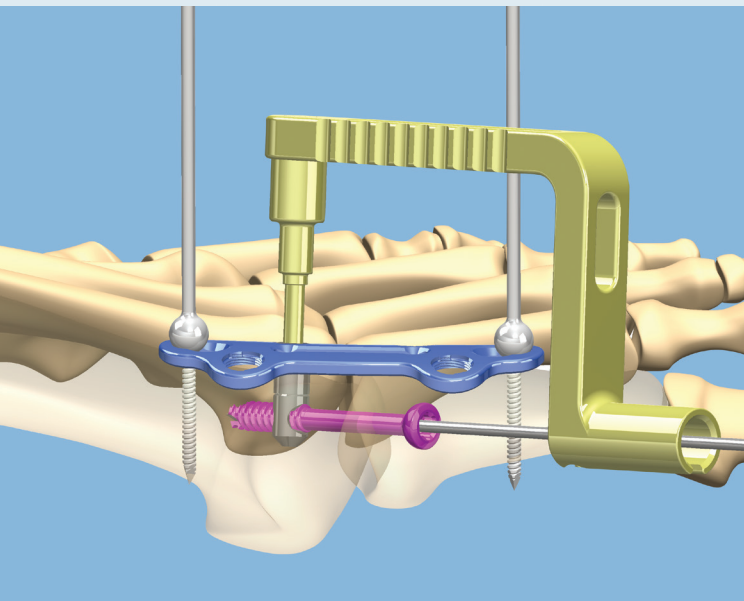

Crossing Screws

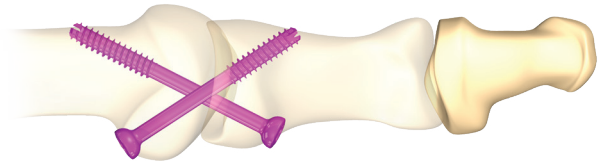

3.5mm Cannulated Headed Screws

Standard Dorsal Plate

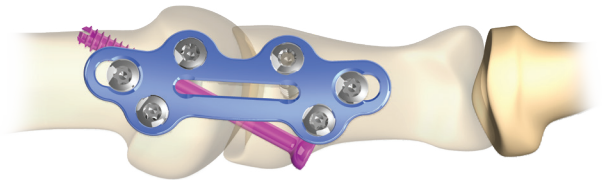

Locking & Non-Locking Screws with interfragmentary screw option

Plate with Nitinol Staple

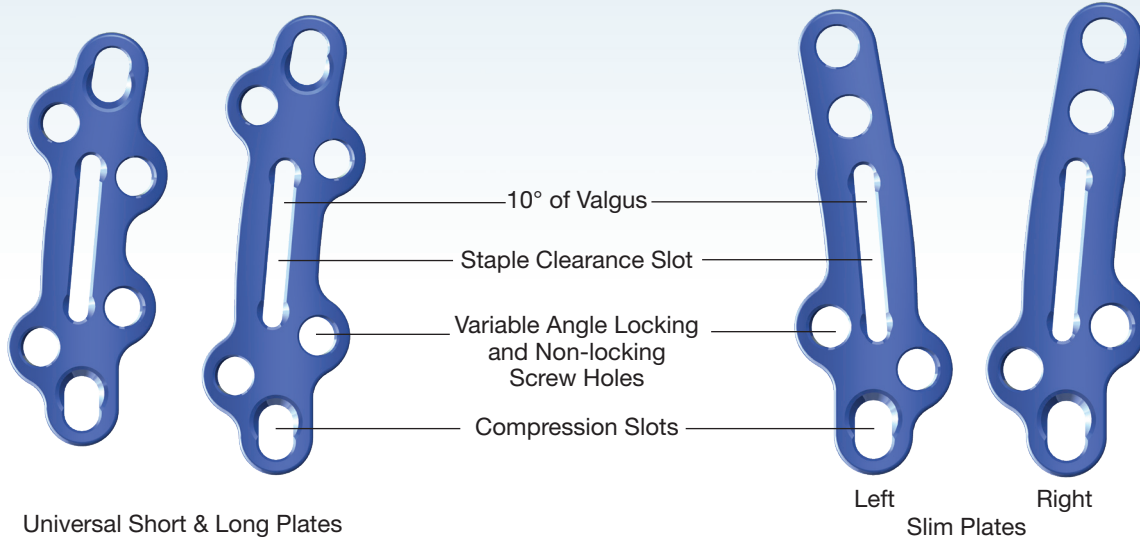

Plate provides clearance for a 15mm Express Staple

OMNI

PLATING SYSTEM
MTP Fusion

Plates



Anatomically Contoured Low Profile Plates



1.5 mm thickness

Screw Offerings

- 2.8 & 3.5mm Solid Variable Angle Locking Screws
- 2.8 & 3.5mm Solid Non-locking Screws
- 3.5 Cannulated Compression Screws

Variable Angle Locking Screws



30° cone of angulation

300 Interpace Parkway
Suite 410
Parsippany, NJ 07054
Phone: 973.588.8980
Customer Service: 888.499.0079
Fax: 888.499.0542
www.extremitymedical.com



Indications for Use: The OMNI Foot Plating System is intended for use in internal fixation, reconstruction or arthrodesis of the 1st metatarsal phalangeal joint.

Extremity Medical and PlantarFix are trademarks of Extremity Medical, LLC.
©Extremity Medical, LLC. 2017. All rights reserved.
LBL-144-99105 Rev A 11/2017